

# Collegamenti elettrici / Wiring

ON-OFF

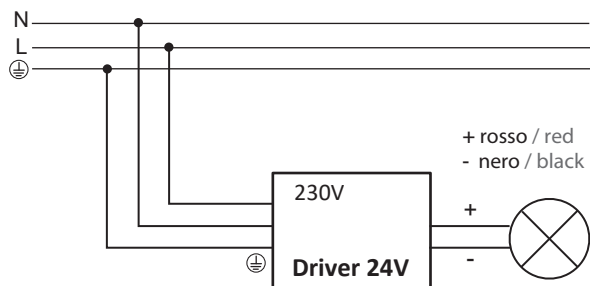

# Infinity

sospensione / hanging

ISTRUZIONI PER L'INSTALLAZIONE  
INSTRUCTIONS FOR INSTALLING  
MODE D'INSTALLATION  
MONTAGEANWEISUNGEN  
INSTRUCTIES VOOR HET INSTALLEREN  
INSTRUCCIONES PARA INSTALACION

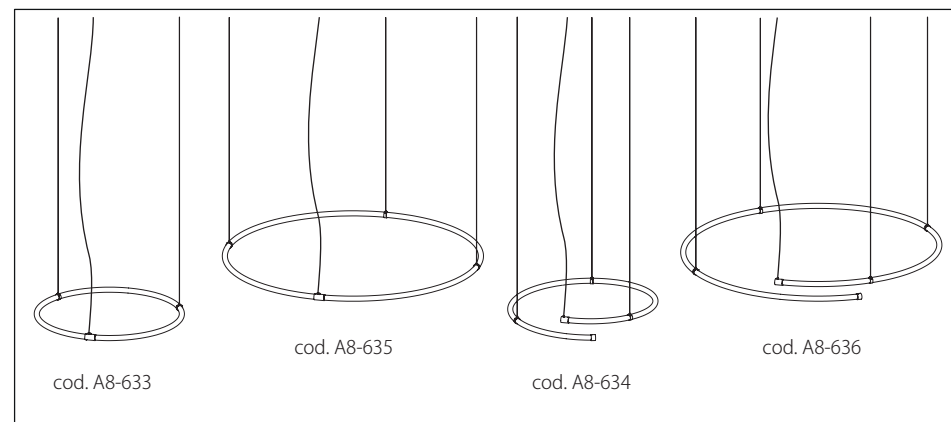

**ATTENZIONE:**

La sicurezza dell'apparecchio è garantita solo dall'uso appropriato delle seguenti istruzioni, pertanto è necessario rispettarle e conservarle.

**WARNING:**

Device security is guaranteed by the appropriate use of the following directions, therefore it is required to follow and to keep them.

**ATTENTION:**

La sécurité de l'appareil n'est garantie que dans le respect des instructions suivantes, Nous vous conseillons donc de les bien conserver.

**ACHTUNG:**

Die Gerätsicherheit ist versichert unter der Voraussetzung, daß die folgenden Einleitungen richtig verwendet und eingehalten werden. Deshalb ist es notwendig, sie zu bewahren

**ATTENTIE:**

De veiligheid van het armatuur is alleen gegarandeerd bij het juist toepassen van de volgende montage-voorschriften.

**ATENCIÓN:**

La seguridad del aparato se garantiza solo cumpliendo cuidadosamente las siguientes instrucciones; por ello, es necesario conservarlas.



**I** Apparecchio predisposto per il montaggio diretto su superfici normalmente infiammabili.

**GB** Device fitted for directly mounting onto normally inflammable surfaces.

**F** Appareil réalisé pour le montage direct sur superficies normalement inflammables.

**D** Leuchte geeignet zur Montage auf normalerweise Flächen.

**NL** Toestellen voorzien voor montage op normaal brandbare oppervlakten.

**E** Aparato preparado para ser montado directamente en superficies inflamables.



**cod. A8-633, A8-634, A8-635, A8-636**

**I** Apparecchio di classe III

**GB** Class III luminaire

**F** Appareil de classe III

**D** Garaet Klasse III

**NL** Toestellen van Klasse III

**E** Aparato de clase III

**I** Gruppo di rischio 1, secondo norma EN 62471:2008

**GB** Risk group 1, in compliance with standard EN 62471:2008

**F** Groupe de risque 1, suivant la norme EN 62471:2008

**D** Risikogruppe 1, gemäß Vorschrift EN 62471:2008

**NL** Risicogroep 1, volgens de norm EN 62471:2008

**E** Grupo de riesgo 1, según norma EN 62471:2008

IP40

**A**= cavo sospensione (\*scorrevole)  
suspension cable (\*sliding)

**B**= rosone  
ceiling cup

**alim**= cavo alimentazione  
power supply cable



Driver 24Vdc remoto da collocare  
in vano ispezionabile a una  
distanza max. di 10m.  
Remote 24Vdc driver to be placed  
in an inspection box (max.  
distance: 10mt).

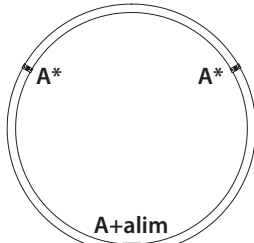
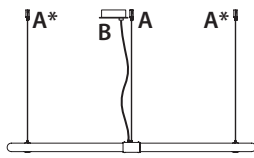

**cod. A8-633**

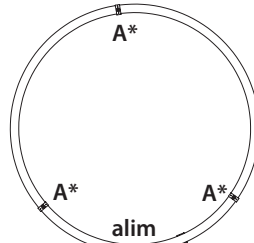
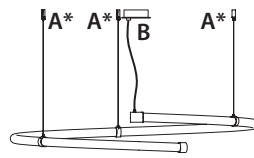

**cod. A8-634**

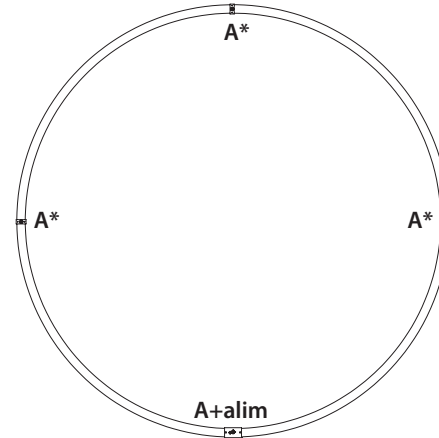
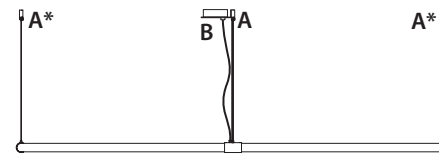

**cod. A8-635**

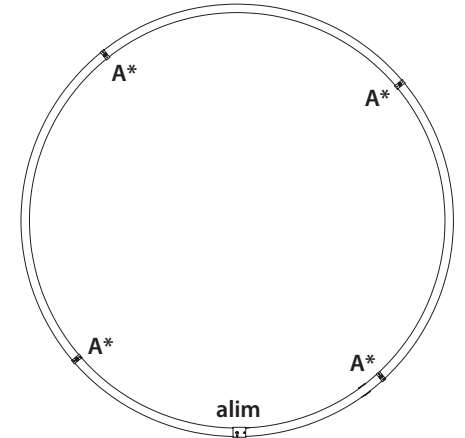
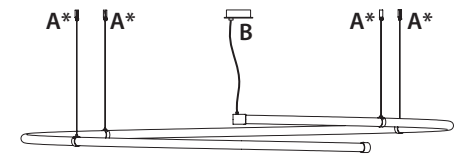

**cod. A8-636**

**A** Cavo sospensione / Suspension cable

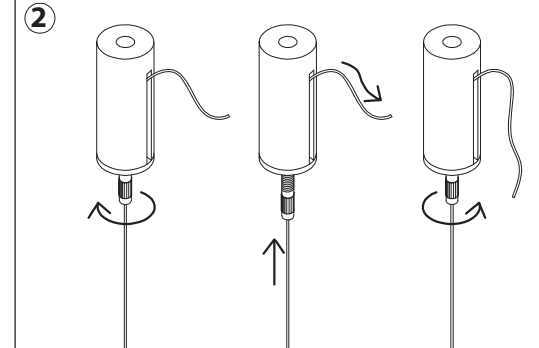
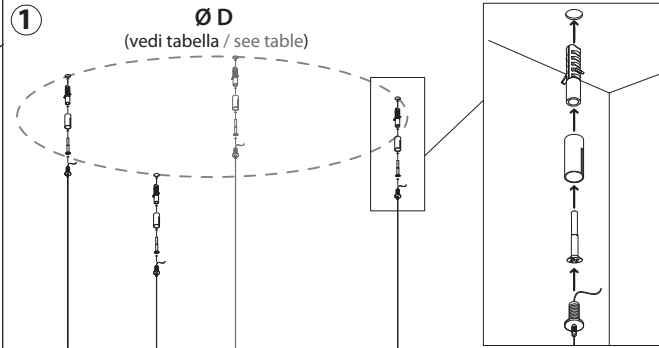
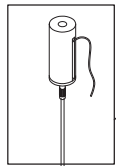

Solo cavo sospensione scorrevole (A\*)  
Sliding suspension cable only (A\*)

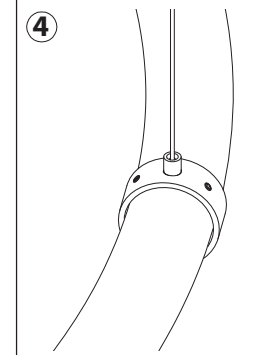
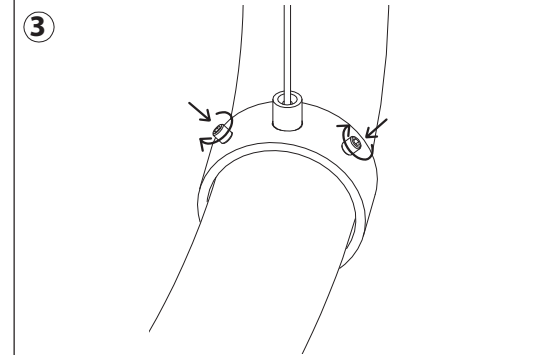
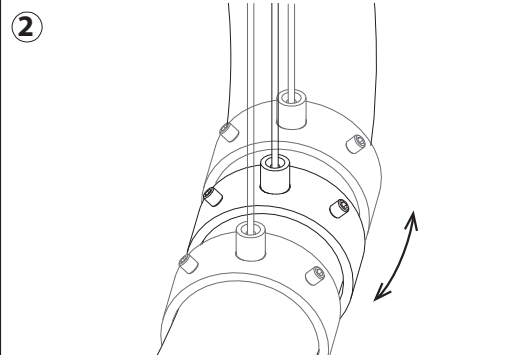
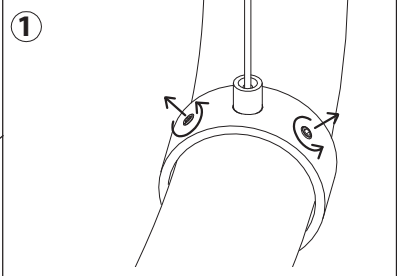

**B Rosone / Ceiling cup**

**cod.A6-019E1024**

**1**

Driver 24Vdc remoto da collocare in vano ispezionabile.  
Remote 24Vdc driver to be placed in an inspection box.

**2**

**3** vedi "COLLEGAMENTI ELETTRICI" see "WIRING"

**4**

**5**

**cod.A6-019U1024**

**1**

Driver 24Vdc remoto da collocare in vano ispezionabile.  
Remote 24Vdc driver to be placed in an inspection box.

**2**

**3**

**4**

**cod.A6-019B1024**

**1**

45

min. 80

**2** vedi "COLLEGAMENTI ELETTRICI" see "WIRING"

**3**

**4**

**5**

**5** vedi "COLLEGAMENTI ELETTRICI" see "WIRING"

**6**

**cod.A6-019R1024**

**1**

40

min. 120

**2**

**3**

**4**

**cod.A6-019L1024...**

**1**

**2** vedi "COLLEGAMENTI ELETTRICI" see "WIRING"

1

230V

driver 24V

3

4

2

+ rosso / red  
- nero / black

**5** vedi "COLLEGAMENTI ELETTRICI" see "WIRING"

230V

driver

N.B. In caso non fosse possibile inserire il driver per motivi di altezza, sarà necessario posizionarlo in un vano ispezionabile.  
N.B. If it is impossible to insert the driver for height reasons, it will have to be placed in an inspection box.

**6**

**7**

**8**

switch ON

**3**

**4**